

THE CONGREGATION KENESETH ISRAEL, INC.

N/F
ALICE LIMBERGER

← ATLAS ASSOCIATES →

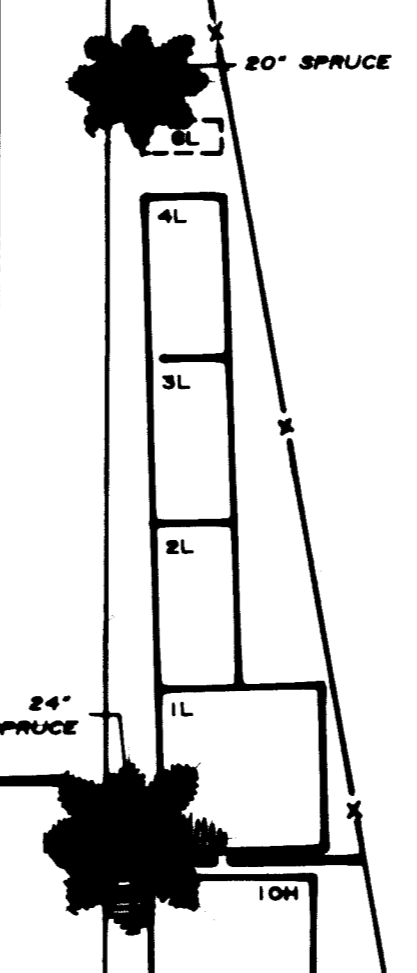
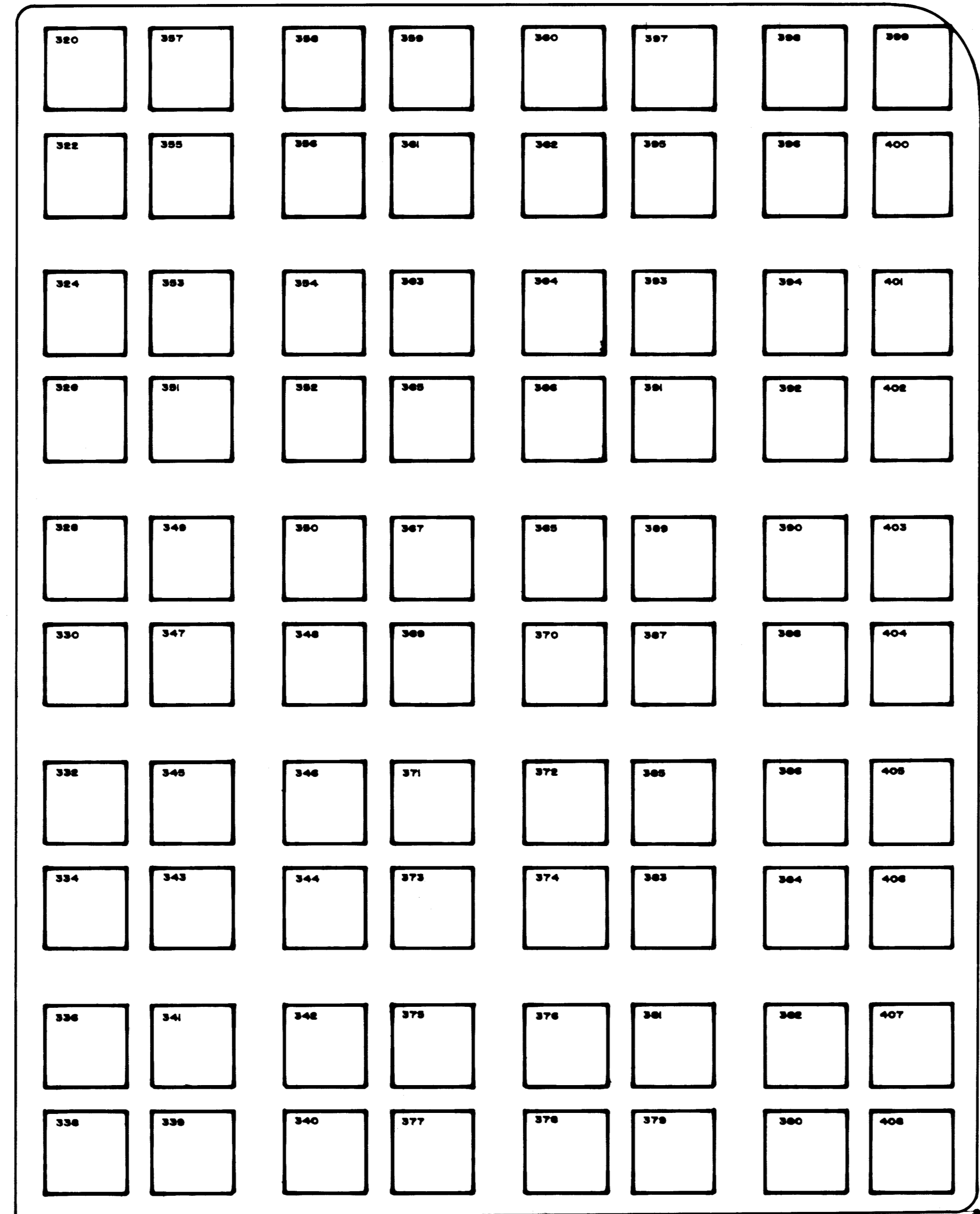
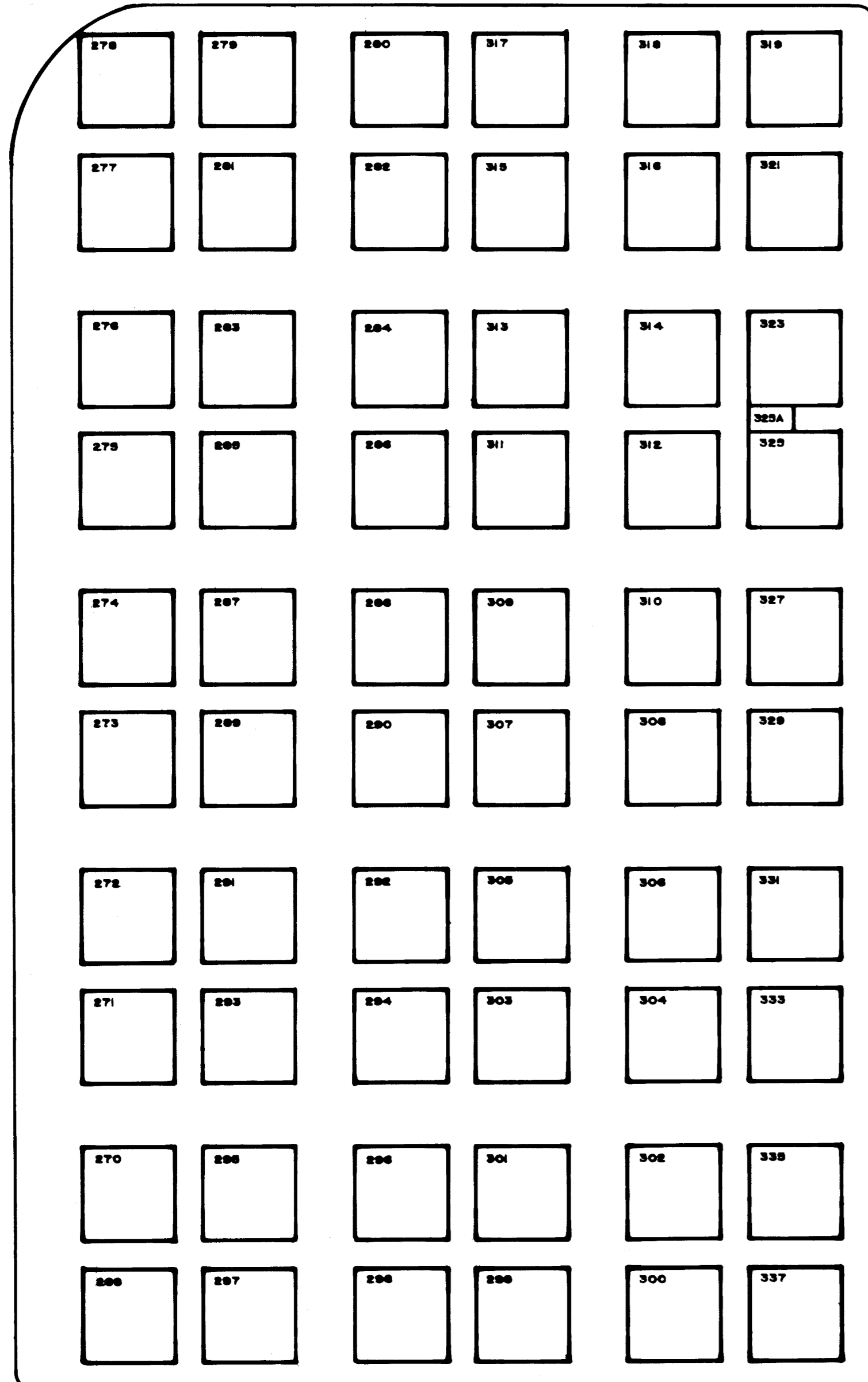

**SECTION VIII
(FUTURE)**

SECTION II

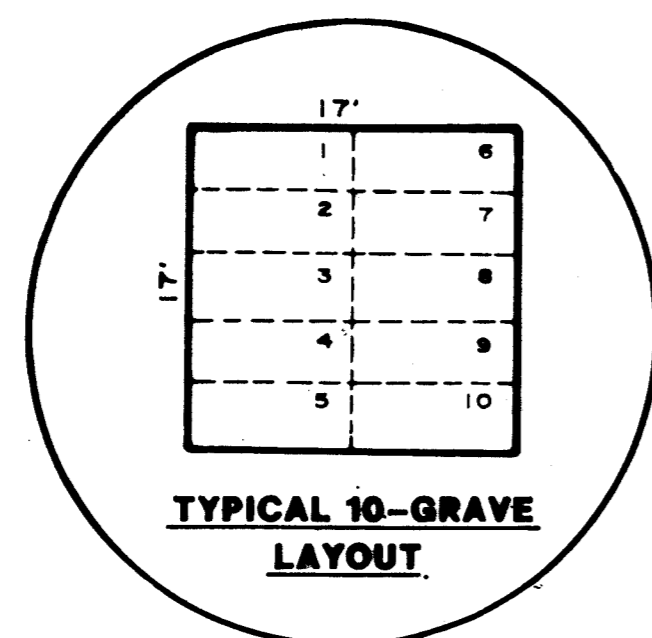

**TYPICAL 10-GRAVE
LAYOUT**

SECTION IV

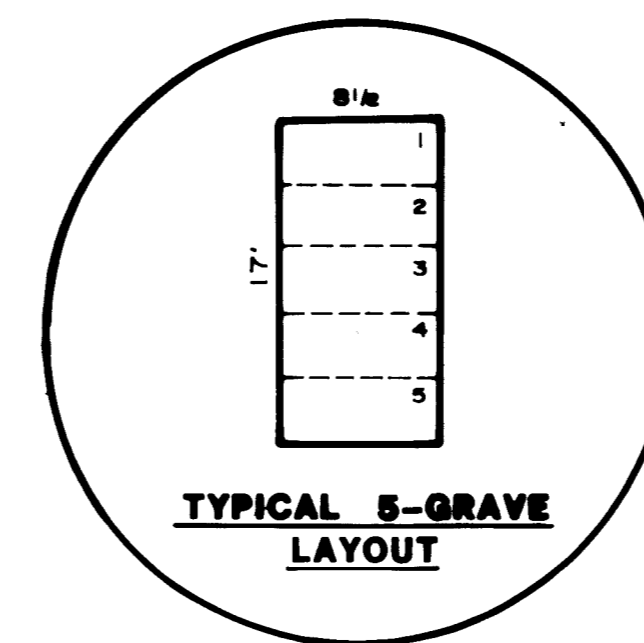

**TYPICAL 5-GRAVE
LAYOUT**

**SECTION III
ELLINGTON CEMETERY**

Scale: 1" = 20'